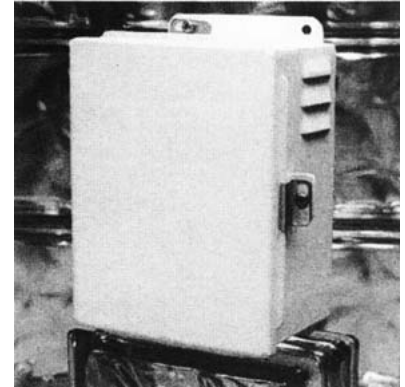

Weatherstation**I/WS****Product Description**

The I/WS is designed to provide protection in both indoor and outdoor environments. It will provide protection from rain, sleet, snow, or against dripping water.

It is made of 16 gauge G-90 grade galvanized steel and is coated with a white enamel. This unit has a drip shield top and seam free sides, front and back. The knockouts are on the bottom of the enclosure and no gaskets are required. A panel and weldnuts are included for mounting all components inside of the weatherproof station. Louvres are located in both the lower left hand side and on the upper right hand side to allow air flow through the housing. Stainless steel clamps on three sides of the cover assure a watertight seal. The cover can be removed by pulling the stainless steel hinge pin. The housing will be coated with a white polyester powder coating on both the inside and outside.

Product Specifications**Housing Size:**

8.00" x 6.00" x 4.00"

Panel Size:

6.75" x 4.88"

Dimensions

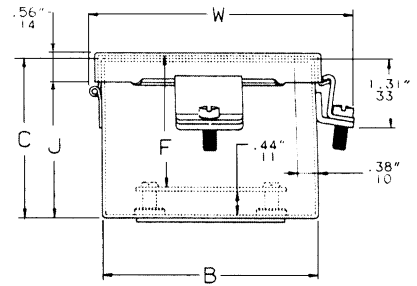
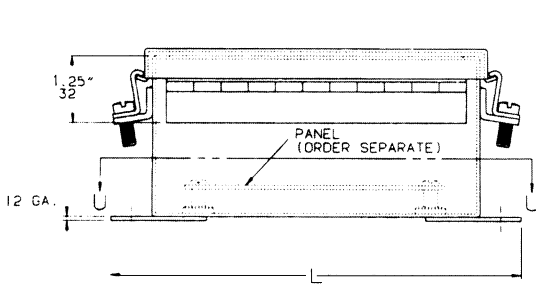

C495-C

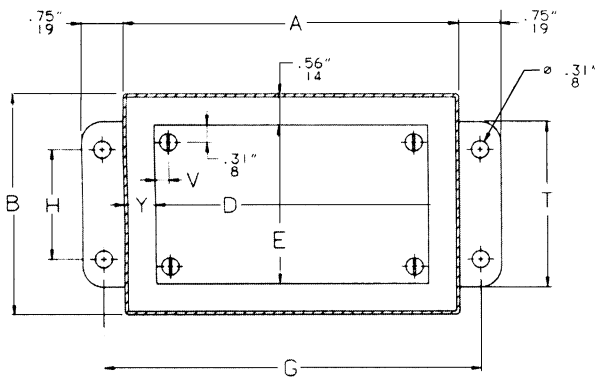

SECTION U-U

NOTE: 1. Panels are 14 gauge steel.
2. Panel screws are #10-32 pan head.

Gauge	Box Size AxBxC	*Panel Catalog Number	Panel Size DxE	Mounting GxH	Overall LxW	F	J	K	N	T	V	Y
14	8.00x6.00x3.50 (203x152x89)	A-8P6	6.75x4.88 (171x124)	8.75x4.00 (222x102)	9.50x6.94 (241x176)	3.00 (76)	3.06 (78)	2.38 (60)	3.38 (86)	5.00 (127)	0.25 (6)	0.62 (16)

Ordering Information

I/WS