

GENERAL INFORMATION

W modules (all except WD 542-544) can be for wall or panel mounting by MW 1 terminal board and Rack 19" or flush mounting by MW 2 terminal board.

MWD 1 as MW 1 but only for WD 542-544.

MWD 2 as MW 2 but only for WD 542-544.

Each module needs one terminal board unit.

WALL OR PANEL MOUNTING (Fig. 1)

- Mount MW 1 or MWD 1 terminal board unit to the wall, by two screws ①.
- Make electrical connections to terminals as per wiring diagrams shown on module data sheets.
- Mount on module housing the two stay rods ② with relevant springs ③, fitted with terminal board.
- Insert instrument into terminal board.
- Screw the two stay rods ② locking instrument to terminal board.

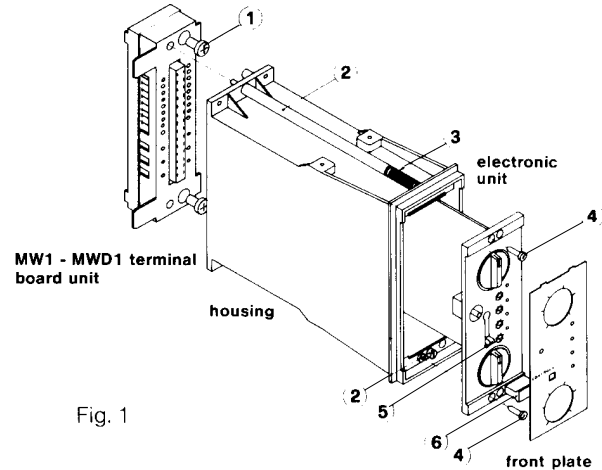

Fig. 1

FLUSH MOUNTING (Fig. 2)

Insert the instrument in the panel (panel cut-out 131.5 x 57 mm). Panel must have thickness max 3.5 mm. Screw the two screws ① vertically positioning the small plates and locking the instrument to the panel.

To mount several instruments:

- Make a panel cut out 131 mm x (62" x n) - 4 mm (n is the number of instruments).
- Screw the two linkages ②, one on upper side and one on lower side of instrument housing.
- Insert the terminal board unit MW 2 in the base of instruments by the plug-in device, locking the unit by the two screws ④.
- Make the electrical connections to terminals as per wiring diagrams shown on module data sheets.

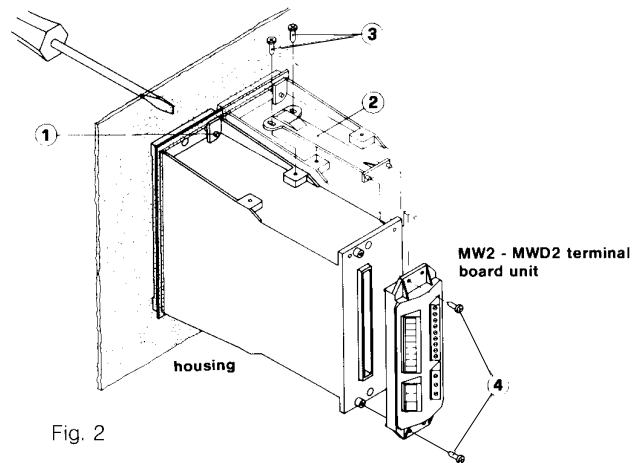

Fig. 2

RACK 19" MOUNTING

- Unscrew the two screws ③ and take out the front electronic card unit pulling handle ④.
- Place in the Rack guides and insert the front/electronic card unit.
- Lock the unit by the two screws.
- Insert the terminal board unit MW 2 or MWD 2 in the base of instrument, locking the unit by the two screws.
- Make electrical connections to terminals as per wiring diagram shown on module data sheets.

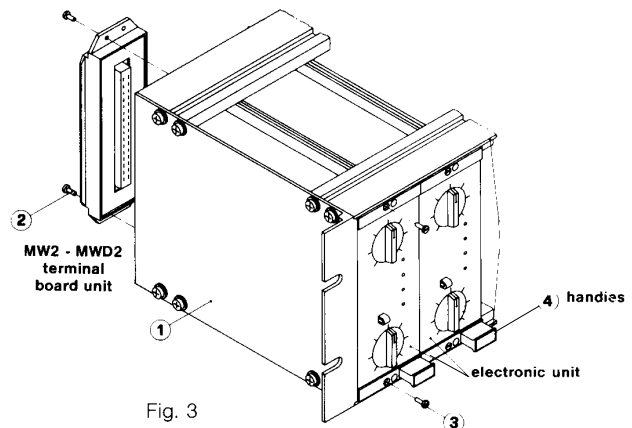

Fig. 3

INSTRUCTIONS TO REMOVE FRONT PLATE

To remove front plate (see Fig. 4) proceed as follows:

- Push plastic button ③.
- Take out plate extracting the two teeth from their seats (on the top of housing).

To re-mount front plate proceed as follows:

- Insert the two teeth of plate in their seats (on the top of housing).
- Push down front plate.

To calibrate trims adjusters it is necessary to remove front plate.

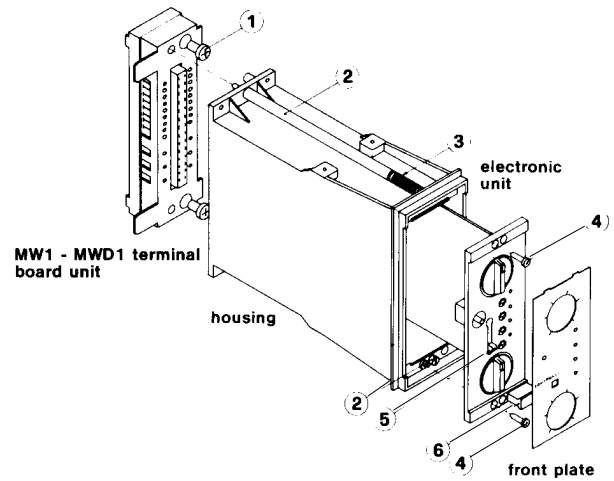

DIMENSIONS (mm)

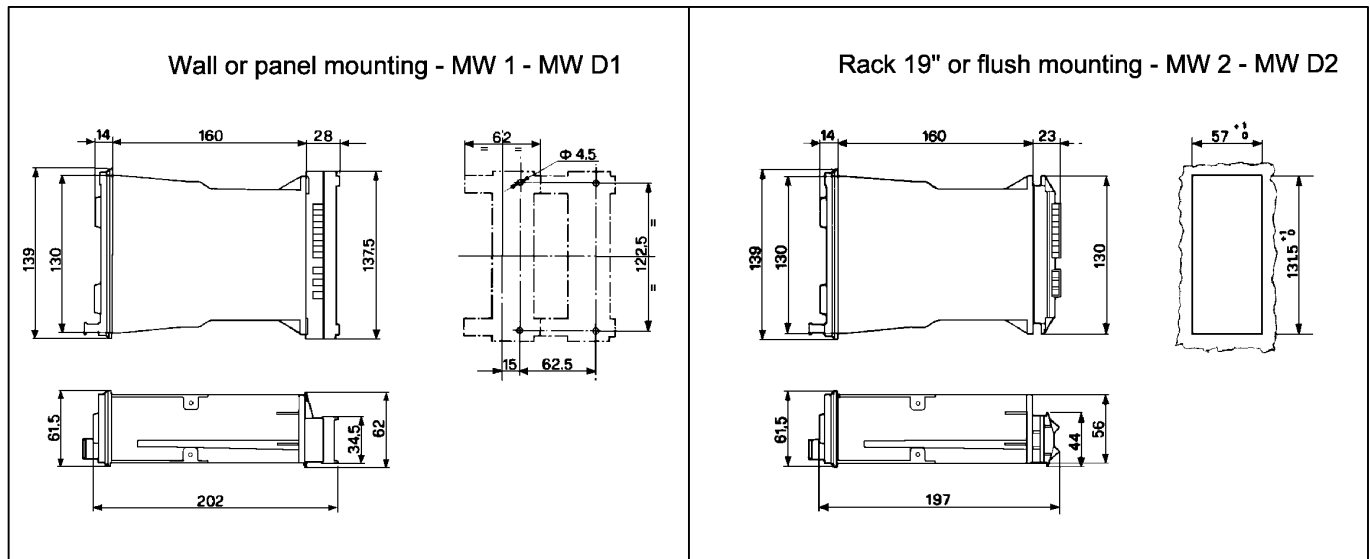

The performances stated in this sheet can be modified without any notice.